

TILLAMOOK COUNTY SURVEYORS OFFICE
COURTHOUSE, TILLAMOOK, OREGON 97141

INITIAL POINT YANKEE BRANCH
SECTION 17 T.1S., R.9W., W.M.

INITIAL
POINT
YANKEE
+
BRANCH
1991

I found a 2" iron pipe with a 1/2" iron rod inside.
The top was approximately 8" below the surface of
the ground, (See T.C.S. Map #C-420).
I set a 3" Tillamook County Surveyors Brass Cap on
A 5/8" x 12" iron rod inside of the found iron pipe,
top approximately 2" above the ground, and encased
in concrete

History of found monument

I found this monument to be as described in said T.C.S. Map #C-420.

Location of Monument

This Initial Point is located on the North side of a corner fence
post. The fence runs North and West from this corner.

In the presence of Al Dvorak

October 31, 1991

Title:

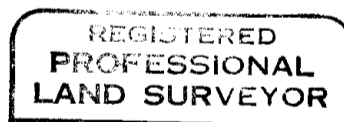
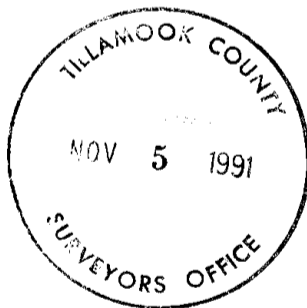

Allan E. Duncan, C.S.

